



**Far North
District Council**



Te Kaunihera o Tai Tokerau ki te Raki

AGENDA

Supplementary Reports

Te Hiku Community Board Meeting

Tuesday, 6 October 2020

Time: 10:00 am
Location: Mangonui Cruising Club
5 Silver Egg Road
Mangonui

Membership:

Chairperson Adele Gardner
Member Darren Axe
Member Sheryl Bainbridge
Member Jaqi Brown
Member John Stewart
Councillor Felicity Foy

Order Of Business

Notice of Motion..... 4

S.1 Notice of Motion - Concept Plans for Allen Bell on Parkdale Playground,
 Awanui Playground, Korora Park, Ahipara and Unahi Wharf. 4

NOTICE OF MOTION

S.1 NOTICE OF MOTION - CONCEPT PLANS FOR ALLEN BELL ON PARKDALE PLAYGROUND, AWANUI PLAYGROUND, KORORA PARK, AHIPARA AND UNAHI WHARF.

File Number: A2965557

I, Member Adele Gardner, give notice that at the next Te Hiku Community Board meeting to be held on 6 October 2020, I intend to move the following motion:

MOTION

That the Te Hiku Community Board,

- a) adopts the Te Hiku Community Board Strategic Plan 2020-2021 as the overarching document that will guide the Community Board in identifying, confirming and allocating funding to its strategic and community planning projects.**
- b) receives the concept plans for Ahipara, Karikari and Awanui for the purpose of using the information to understand community priorities and guide the Community Board's decision making and funding allocations in a way that will meet the needs of communities and promote the social, economic, environmental and cultural well-being of communities as required by the Local Government Act 2002.**
- c) requests that a directory is set up within Governance for its strategic plan, current and future community plans, concept plans and other relevant documents so that the plans are available to current and future Community Board members for implementation and review.**
- d) requests community plans are added to the Council website so that they can be accessed by members of communities.**

RATIONALE











The Te Hiku Community Board has prepared its strategic plan for the 2020/2021 year and has attached it for adoption so that it has recognition within the system and can be used as a basis for funding allocation and forward planning.

Community Plans are prepared by and for communities but are valuable tools that enable the Board to understand community priorities and to assist with decision making and funding allocation. For this reason, the Board wishes to receive the community plans for Ahipara, Karikari and Awanui as a basis for achieving this purpose.

The Board has concern's that previous community plans have not been kept up to date. The Board therefore asks that current and future plans are available on request by having a directory set up these documents. It also requests that community plans are made available on the Council website for the benefit of access by current and future community members.

I commend this Notice of Motion to the Te Hiku Community Board for consideration.

ATTACHMENTS

- 1. Notice of Motion - Adoption of the Strategic Plan 2020/2021 and Community Plans - A2969059**  
- 2. Te Hiku Community Board Strategic Plan 2021-2031 - A2969074**  
- 3. Allen Bell Reserve Park Concept - A2966622**  
- 4. Awanui Town Centre Park - A2966623**  
- 5. Awanui Open Space Revitalisation Full Masterplan - A2969046**  

6. **Korora Park Landscape Concept Plan - A2966628** [!\[\]\(2824aab9645d9fab95bae27ff6828dab_img.jpg\)](#) 
7. **Unahi Wharf Landscape Concept Plan - A2966631** [!\[\]\(c42d0234b47eca423823087b9f2f5716_img.jpg\)](#) 

NOTICE OF MOTION

I, Adele Gardner (Te Hiku Community Board Chair) give notice that at the next Te Hiku Community Board meeting to be held on 6 October 2020, I intend to move the following motion:

MOTION

That the Te Hiku Community Board adopts the 2020/2021 Te Hiku Community Board Strategic Plan as the overarching document that will guide the Board in identifying, confirming and allocating funding to its strategic and community planning projects;

And that the Te Hiku Community Board receives the community plans for Ahipara, Karikari and Awanui for the purpose of using the information to understand community priorities and guide the Board's decision making and funding allocations in a way that will meet the needs of communities and promote the social, economic, environmental, and cultural well-being of communities as required by the Local Government Act 2002;

And that the Te Hiku Community Board requests that a directory is set up within Governance for its strategic plan, current and future community plans, concept plans and other relevant documents so that the plans are available to current and future community board members for implementation and review;

And that community plans are added to the Council website so that they can be accessed by members of communities.

RATIONALE

The Te Hiku Community Board has prepared its strategic plan for the 2020/2021 year and has attached it for adoption so that it has recognition within the system and can be used as a basis for funding allocation and forward planning.

Community Plans are prepared by and for communities but are valuable tools that enable the Board to understand community priorities and to assist with decision making and funding allocations. For this reason, the Board wishes to receive the community plans for Ahipara, Karikari and Awanui as a basis for achieving this purpose.

The Board has concerns that previous community plans have not been kept up to date. The Board therefore asks that current and future plans are available on request by having a directory set up for these documents. It also requests that community plans are made available on the Council website for the benefit of access by current and future community members.

I commend this Notice of Motion to the Te Hiku Community Board for consideration.

ATTACHMENTS

1. 1 - Te Hiku Community Board Strategic Plan
2. Ahipara Community Plan
3. Karikari Community Plan
4. Awanui Community Plan

Signed: Adele Gardner, Chairman Te Hiku Community Board

A handwritten signature in black ink, appearing to read 'Sheryl Bainbridge', written over a circular stamp.

Sheryl Bainbridge Te Hiku Community Board

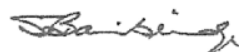
A handwritten signature in black ink, appearing to read 'John Stewart', written in a cursive style.

John Stewart Te Hiku Community Board

A handwritten signature in black ink, appearing to read 'John Stewart', written in a cursive style.

NOTICE OF MOTION

I, Adele Gardner (Te Hiku Community Board Chair) give notice that at the next Te Hiku Community Board meeting to be held on 6 October 2020, I intend to move the following motion:

MOTION

That the Te Hiku Community Board receives the concept plans for Allen Bell on Parkdale Playground, Awanui Playground, Korora Park, Ahipara and Unahi Wharf and adopts them as documents that will assist the Board to confirm and allocate funding to elements of the plans as identified in its strategic and community planning, and during consultation with the relevant communities.

RATIONALE

Earlier in 2020 a copy of the Te Hiku o te Ika Open Spaces Revitalisation Master Plan prepared by Councillor Felicity Foy, Landscape Architect Delwyn Shepherd and others was prepared to provide guidance to assist the Board in identifying, confirming and allocating funding to its community planning projects. Concept plans for Allen Bell on Parkdale Playground, Awanui Playground, Korora Park, Ahipara and Unahi Wharf have been prepared to progress development in these areas as funding becomes available and following consultation with the community.

The Board therefore wishes to formally adopt the concept plans as part of its strategic and community planning process.

I commend this Notice of Motion to the Te Hiku Community Board for consideration.

ATTACHMENTS

1. Concept Plan – Allen Bell on Parkdale playground
2. Concept Plan – Awanui Playground
3. Concept Plan – Korora Park, Ahipara
4. Concept Plan – Unahi Wharf

Signed: Adele Gardner, Chairman Te Hiku Community Board



Sheryl Bainbridge Te Hiku Community Board

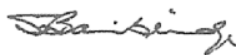

John Stewart Te Hiku Community Board



Te Hiku Community Board

Strategic Plan 2020-2021

And Setting the Direction for The Long Term Plan 2021-31





Adele Gardner

Representative for the Kaitaia subdivision and Chairperson of Te Hiku Community Board.



Sheryl Bainbridge

Representative for the Doubtless Bay subdivision of Te Hiku Community Board.



Jaqi Brown

Representative for the Kaitaia subdivision of Te Hiku Community Board.



Darren Axe

Representative for the North Cape subdivision of Te Hiku Community Board.



John Stewart

Representative for the Kaitaia subdivision of Te Hiku Community Board.



Bill Subritzky

Representative for the Whatuwhiwhi subdivision



Felicity Foy

Council appointed representative to the Te Hiku Community Board

Role of Community Boards

Under Section 52 of the Local Government Act 2002 the role of a community board is defined as being to:

- (a) represent, and act as an advocate for, the interests of its community; and
- (b) consider and report on all matters referred to it by the territorial authority, or any matter of interest or concern to the community board; and
- (c) maintain an overview of services provided by the territorial authority within the community; and
- (d) prepare an annual submission to the territorial authority for expenditure within the community; and
- (e) communicate with community organisations and special interest groups within the community; and
- (f) undertake any other responsibilities that are delegated to it by the territorial authority.

Community Board Vision, Mission and Priorities

Vision

“To strengthen, support and uphold the wellbeing, prosperity, economic recovery and resilience of Te Hiku O Te Ika.”

Mission

“To engage at all levels with our communities to ensure that the development and provision of facilities and services, are fit for purpose, aesthetically pleasing and sustainable and follow a transparent, fair and safe process that meets the needs of the Te Hiku Ward”

Priorities

The community board may recommend local service levels and asset development priorities for civic amenities as part of the annual plan and long term plan processes conducted by Far North District Council. The strategic plan sets out these recommendations. The Board's strategy for **2020/2024** and beyond will be to link development in communities of interest to the Te Hiku o Te Ika Open Spaces Revitalisation Master Plan **that was adopted by the Board at its meeting of 25 August 2020** and other documents which may include new and existing Community and local development plans, the Northland Walking and Cycling Strategy, NZTA Awanui township plan and other relevant documents. Plans will acknowledge the natural environment, community, culture, built environment and economy as well as economic recovery and community resilience.

Te Hiku Community Board recommends that the Placemaking Budget be implemented to a level that services the community for the 2021-2024 Long Term Plan.

Item	Detail	Rationale	Priority	Year	Support information
Te Hiku o Te Ika Open Spaces Revitalisation Master Plan (includes Kaitaia)	Start to implement	To understand community priorities and guide the Board's decision making and funding allocations and for economic recovery.	1	2020/2031	To incorporate Centennial Park. Allen Bell Park concept plans for the upgrade with costings for LTP
Awanui Community Plan	Developed, review and where possible begin to implement	To understand community priorities and guide the Board's decision making and funding allocations and for economic recovery.	1	2020-2024	To incorporate Unahi concept plan and upgrade Awanui Playground concept Plan with costings for LTP
Ahipara Community Plan	Developed 2012, review and where	To understand community priorities and guide the Board's decision making and funding	1	2020-2024	To incorporate upgrade of Korora Park concept plan with

	possible begin to implement	allocations and for economic recovery.			costings for LTP. Acknowledge Takiwa plans
Pukenui/Houhora Community Plan	Developed 2009, review and where possible begin to implement	To understand community priorities and guide the Board's decision making and funding allocations and for economic recovery.	1	2020-2024	To incorporate walkway from the commercial wharf to Lamb Road bridge designed and delivered as part of Pukenui Wharf project to be managed by FNHL
Doubtless Bay Community Plan	Develop, and where possible begin to implement	To understand community priorities and guide the Board's decision making and funding allocations and for economic recovery.	1	2020-2024	To incorporate plans for Mill Bay and Taipa childrens playground/activity zone
Karikari Peninsula Plan	Developed 2018, and where possible begin to implement	To understand community priorities and guide the Board's decision making and funding allocations and for economic recovery.	1	2020-2024	To incorporate Karikari Recreation hub plan and management plan
Taipa Oruru Peria Paranui	Developed, review and where possible begin to implement	To understand community priorities and guide the Board's decision making and funding allocations and for economic recovery		2020-2024	To be adopted when reviewed
Kaitaia Community Plan	Developed 2009, review where possible begin to implement	To understand community priorities and guide the Board's decision making and funding allocations for economic recovery		2020-2024	To be reviewed

Future Priorities (LTP 2021-31)

Amenity Lighting

Item	Detail	Rationale	Priority	Year	Support information
Smart light	Awanui reserve	Provide wifi & light for responsible campers		2023-2024	Awanui Community Plan, NZTA Township Plan

Lighting	Allen Bell Park	Health and safety			To be costed
Lighting	Centennial Park near toilets and up-lighting for trees		1		Budget available and lighting plan to be approved.
Lighting	Karikari Rec Hub multi-courts				Include in Karikari Recreation Plan and be costed
Street lighting	Cnr Okahu and Kaitaia-Awaroa Road	Health and safety			Integrated Transport Strategy
Street lighting	State Highway Coopers Beach	Health and safety			NZTA - Integrated Transport Strategy
Street lighting	Waterfront Drive Mangonui	Health and safety – high use pedestrian area in summer		2021-2024	Council AMP, NZTA, Mangonui Development Committee
Street lighting	Kaitaia township – North Park to Moerua Park incl. service lanes	Community Safety			To be reviewed and costed
Street lighting	Donald Road Kaitaia	To cater for new 60-lot subdivision			Te Rarawa
Street lighting	Allen Bell Drive to Pak n Save and Warehouse	Community Safety			
Street lighting	George St Mangonui	Health and safety			LTP
Street lighting	Northwood Ave Pukenui to existing lighted area	Health and safety – 80kph zone			Integrated Transport Strategy
Street lighting	Masters Access Rd and Ahipara Road intersection	Health and safety			Integrated Transport Strategy
Street Lighting	Along North Road from Mitre 10 to Whangatane Drive	Health & Safety			Integrated Transport Strategy
Street Lighting	New roundabout (yet to be built) on Matthews Ave and North Road Kaitaia	Health & Safety			Integrated Transport Strategy

Street Lighting	Mission Place st to corner opposite Anglican Church Kaitaia	Health & Safety			To be reviewed & costed
-----------------	---	-----------------	--	--	-------------------------

Footpaths

Item	Detail	Rationale	Priority	Year	Support information
Footpath	Bridge on Simon Ulrich Rd and nearby Tokerau Beach Road and Melissa Road to Waitotaraire Park entrance	Pedestrian safety	1	2021-2022	Complaints from ratepayers Assn
Footpath	Paramatta Nexus to Marriene Place Karikari Peninsula	Pedestrian Safety			Add to matrix
Footpath	Houhora Heads Road from camp to state highway	Pedestrian safety			Formed metal footpath only to be costed for matrix/LTP
Footpath	Mill Bay Road to Beach Road Mangonui	Pedestrian safety			Staged to incorporate future Mill Bay development to be costed for matrix Integrated Transport Strategy
Footpath	Kotare Drive Coopers Beach	Link from Mangonui to eastern end of Coopers Beach and pedestrian safety			Already on matrix but the importance of the link to be noted
Footpath	Taupata Place Kaitaia	Pedestrian safety and accessibility -2 lengths – 1x10m RH and 1x 20-30m LH			Add LH to matrix To be costed – Integrated Transport Strategy
Footpath	Norman Senn Ave to Pukemiro School Kaitaia	Pedestrian safety especially children – RH side of road proximity to school			To be costed and added to matrix – Integrated Transport Strategy
Footpath	Whatuwhiwhi Road to Perehihi Reserve	Pedestrian safety			To be costed for matrix

Footpath	Outside Ahipara School to new subdivision	Pedestrian safety especially children – proximity to school			To be costed – Integrated Transport Strategy
Footpath	Along Cable Bay Block Road to Pekama Drive Coopers Beach	Pedestrian safety especially children	1		To be costed added to matrix Integrated Transport Strategy
Footpath	SH10 between Col Mould Drive and Mangonui turnoff at the bottom of the hill	Pedestrian safety and accessibility, pedestrian link			To be costed for matrix– Integrated Transport Strategy

Note: The current footpath matrix does not recognise the value of walking/cycling, the volume of pedestrian traffic at marae or urupa and does not give sufficient consideration/weight to pedestrian safety.

Cycleways

Item	Detail	Rationale	Priority	Year	Support information
Cycleway/walkway	Kaitaia to Ahipara via the roadside – Twin Coast Discovery	Safety for cyclists and Te Araroa trail walkers Regional Land Transport Plan	1	2030-2031	Kaitaia Community Plan, Ahipara Community Plan. Has been costed Te Hiku Open Spaces Master Plan. Integrated Transport Strategy – add to LTP
Cycleway	Kaitaia to Awanui		2		Via SH1. Cycle trail to follow in LTP – costed Te Hiku Open Spaces Master Plan - Integrated Transport Strategy - add to LTP
Cycleway	Karikari		4		Utilising paper roads - add to LTP
Cycleway	Awanui to Waipapakauri Ramp		3		T Hiku Open Spaces Master Plan. Spains Road, connecting to Lake Ngatu walkway to Waipapakauri Ramp – Integrated Transport Strategy - add to LTP

Cycleway In Kaitaia CBD	Develop a safe cycleway around the CBD of Kaitaia	Safety for cyclists			Integrated Transport Strategy Add to LTP
--------------------------------	---	---------------------	--	--	--

Walkways

Item	Detail	Rationale	Priority	Year	Support information
Walkway	Mangonui waterfront to connect existing footpaths – possibly extending to Paewhenua Island	Active transport and visitor experience. To be staged	4	2021-2031	Mangonui development working group submissions. Integrated Transport Strategy. Add to LTP
Scenic Walkway	End of Foreshore Road to Te Kohanga (Shipwreck Bay) Ahipara	Local and visitor experience	5		Northland Walking & Cycling Strategy focus 2 promoting Northland's coastal point of difference and 3 improving community wellbeing including creating economic opportunities. Integrated Transport Strategy
Scenic Walkway Pukenui Wharf and Walkway	Commercial wharf to Lamb Road Bridge Pukenui 465 metres	Local and visitor experience. FNHL to project manage	1	2021-2022	Northland Walking & Cycling Strategy focus 2 promoting Northland's coastal point of difference and 3 improving community wellbeing including creating economic opportunities Integrated Transport Strategy
Scenic Walkway	Waterfront Road to Houhora Heads from commercial wharf	Local and visitor experience	2		Northland Walking & Cycling Strategy focus 2 promoting Northland's coastal point of difference and 3 improving community wellbeing including creating economic opportunities Integrated Transport Strategy
Scenic Walkway Stage 2	Link Boardwalk to Arethusa Reserve	Local and visitor experience	3		Northland Walking & Cycling Strategy focus 2 promoting Northland's coastal point of

	Houhora (1.5km walk) Stage 2 of above				difference and 3 improving community wellbeing including creating economic opportunities
Scenic Walkway	Ahipara Gumfields	Local and visitor experience			Northland Walking & Cycling Strategy focus 2 promoting Northland's coastal point of difference and 3 improving community wellbeing including creating economic opportunities Integrated Transport Strategy

Note: The Board supports any initiative by the Bay of Islands-Whangaroa Community Board to develop a walkway from Totara North to Taupo Bay as this would provide another recreational option for visitors and locals in Doubtless Bay.

Carparks

Item	Detail	Rationale	Priority	Year	Support information
Off-road carpark	Awanui reserve	Access to public toilets from SH10	2	2022-2023	Awanui Community Plan, NZTA Township Plan. Integrated Transport Strategy
ExWarehouse Kaitaia	Includes 60+ carparks to be purchased by Council	A key area for carparking and to be added to the Market Square	1		Te Hiku Open Spaces Master Plan key areas to be developed
Ex Pac n Save	Investigate options with landowner	Refer to Te Hiku Open Spaces Master plan			

Halls

Item	Detail	Rationale	Priority	Year	Support information
Look at Options for best use/management of halls					

Public toilets

Item	Detail	Rationale	Priority	Year	Support information
Public toilet	Unahi wharf	Provide facilities for wharf users	1	2020-2021	Awanui Community Plan to be costed added to LTP
Public toilet	Herekino	For Twin Coast Discovery walkers	2		To be costed added to LTP
Public toilet	North Park - investigate options for placement of toilet		1	2020-2021	Ex-Centennial Park toilets – renewals - costed
Public toilet	Paua				To be costed added to LTP
Public toilet	Parkdale reserve (Allen Bell Park)	Closer to road where there is a light	1	20/21	To be costed added to LTP
Public toilet	Waitiki Landing investigate options with the Iwi				Subsidy to Ngati Kuri/Muriwhenua for public use over the main holiday period
Public toilet	Pukenui sports field development Araiawa	To serve sports field development	2	21/22	To be costed and added to LTP
Public toilet	Te Kohanga investigate options with Iwi	2-300 visitors per day in summer – tourists and locals	2	21/22	To be costed added to LTP. Liaise with Ahipara groups

Reserves

Item	Detail	Rationale	Priority	Year	Support information
Water fountain	Korora Park				Funds formerly allocated for a foreshore playground to be reallocated to Korora Park

Recreation facilities

Item	Detail	Rationale	Priority	Year	Support information
Activity zone	Taipa	FNHL to consider			Request for pump track
Redevelopment to create car and trailer boat parking, pedestrian links to Rangikapiti Road and	Mill Bay Mangonui	FNHL to consider			Te Hiku ward recreation plan 2008.

Waterfront Road, seating, lighting, toilets					
Karikari Recreation hub	Sports field development			2022/23 (allocated \$127,487)	Karikari Community Plan Community to decide on the allocation and outcome for development
Karikari Watersports HQ	Beach showers and storage for sports gear				To be costed for LTP - Karikari Community Plan
Te Hiku Sports Hub	Enlarge proposed hall to be funded from general rate rather than a targeted rate				
Centennial Park skate park	Renewals				To be part of forward planning
Parkdale Reserve	Drainage, footpaths, fountains, tables		1	20/21	Concept plan developed with costings. Upgrade of childrens playground. Costings for LTP
Te Hapua	School playground				Grant to school? Education Dept?
Rangiputa Boat ramp	More trailer boat parking				Community demand
Perehipe Beach	More trailer boat parking				

Street furniture

Item	Detail	Rationale	Priority	Year	Support information
Picnic tables	Awanui reserve	Attractive community friendly areas	1	21-24	Awanui Community Plan, NZTA Township Plan. Concept Plan
Shade sails	Paripari domain	For over the picnic tables	6		To be costed for LTP
Shade sails	Pukenui playground				
Memorial Seat for Lawrie Atkinson	Awanui Playground or Karikari Peninsula				Beautification Budget

Public art

Item	Detail	Rationale	Priority	Year	Support information
Historical storyboards	Awanui reserve	Visitor experience, proud vibrant communities	1	2022-22	Awanui Community Plan, NZTA Township Plan

Signage

Item	Detail	Rationale	Priority	Year	Support information
Kaitaia welcome sign	NZTA road reserve on North Rd	Proud vibrant communities	2	2021-2024	Kaitaia Community Plan. To be done in conjunction with KBA

Litter

Item	Detail	Rationale	Priority	Year	Support information
Recycling bins	Awanui reserve	Waste minimisation	1	2021-2024	Community Plan, NZTA Township Plan
Rubbish bins and recycling	Waipapakauri Ramp	Refuse from Te Araroa trail users and general public	1	2021-2024	

Town beautification and maintenance

Item	Detail	Rationale	Priority	Year	Support information
Trees- Awanui Tree	Awanui Playground				

Overview of services provided by the Council

Item	Detail	Rationale	Priority	Year	Support information
Kaitaia Drainage District, Kaimaumau/Waiharara Drainage District and Motutangi Drainage District	Northern Drainage Districts – ensure that committees are reconstituted following each election	Flood protection Kaitaia and Aupouri peninsula		2023 onwards	Governance and IAMs to follow up and reconstitute after each election period
Sewerage	Pukenui and Houhora	Growing community			Work to be done costed and into LTP
Sewerage/stormwater	Taipa				
Drainage	Fill in the swale drains at Donald Lane	Health and Safety			
Drainage	Karikari – Inland Road from the top of the hill	Flooding issues for residents – remediation works			
Customer Service	Service centre Doubtless Bay	Growing community, current lack of service, economic development			
Community support	Funding for Te Ahu from the ward rate				Te Ahu & Turner Centre to be reviewed by December 2020 - Council Resolution June 2020
Community support	Funding support for Doubtless Bay Information Centre Mangonui	Economic development – increased visitor numbers			Doubtless Bay is a destination. Visitors are not always aware of attractions further north, so Kaitaia, Houhora etc. presently disadvantaged. Figures show that DB Info Centre has as many visitors as Kaitaia i-site

Land acquisition	Kaitaia near tennis court (Kaitaia Tennis Club title- this land is mowed by Council)	Opportunity to develop Centennial Park -			This land was offered from Kaitaia Tennis Club to Council to buy
Land acquisition	Taipa Point south of sailing club	Recreational development opportunities including boat trailer parking to future proof			Taipa point by Taipa Sailing club area.
Roundabout at Pukepoto Rd/Commerce St/Grigg St/ North Road.	In Kaitaia	Traffic Safety			Integrated Transport Strategy
Kerb & Channel Streets that have Open Drains in our residential areas in Te Hiku	This could be part of the road matrix	Health & Safety			Integrated Transport Strategy

Strategic priorities for allocation of community fund

Te Hiku Community Board has decided that operational costs will not be a strategic priority and that the community fund will be targeted to support infrastructure and events. The events annually supported by the board include...

Additional recommendations and strategic priorities

Te Hiku Community Board would like to continue engaging with youth as part of their community engagement

Allen Bell Reserve Park Concept



The Bike Park is to be constructed with local natural materials giving the look and feel of being out in the country side.

Trees will create summer shade and bring birds into the park. The riverside will feature large areas of riparian plantings.

This park will have easy summer swimming access under the existing Potutukawa and Morton Bay trees.

The intention of this Bike Park is to incorporate both BMX pump track circuits along with a mountain bike track enabling all ages and skill levels to use the Bike Park.

-  Umbrella & BBQ
-  Swimming hole & large lawn close to river
-  BMX Hills to ride over and ride through tunnels
-  Bike trails on stopbanks & around park
-  Shared path along river edge and park
-  Public Toilets
-  New Playground beside existing court and public toilet
-  Existing Playground retained for Terry Cres Tamariki
-  Existing Basketball Court
-  Amenity trees retained
-  Pohutukawa shade trees
-  Riparian plantings
-  Overland flood flow path
-  Flood protection lower level
-  Stop Banks flood protection

30/07/2020 Amended 22/09/2020

 XCAPE DESIGN LTD
LANDSCAPE ARCHITECTS
0272810640
delwyn.shepherd57@gmail.com



- Umbrellas
- Concrete tables
- Basketball half court
- Concrete path
- Concrete areas
- Bollards
- Timber Wharf
- Nikau
- Pohutukawa

Awanui Town Centre Park



The current Awanui park has the potential to become a multi purpose park for all to enjoy. The park will connect with the Awanui River by way of a crossing and timber wharf. There will be pedestrian links with the retirement village.





Awanui Township

The masterplan includes works within centralised precincts within the Awanui township and along the Awanui River to provide improved connections within the township and to create centralised vibrant spaces to facilitate improved economic development.



-  Umbrellas
-  Concrete tables
-  Basketball court
-  Concrete path
-  Concrete areas
-  Bollards
-  Timber Wharf
-  Nikau
-  Pohutukawa

Awanui Town Centre Park



The current Awanui park has the potential to become a multi purpose park for all to enjoy. The park will connect with the Awanui River by way of a crossing and timber wharf. There will be pedestrian links with the retirement village.





Old navigation Buoy from Rangaunu Harbour

Feature entrance Buoy location ideas;

- 1 New wharf entrance
- 2 New carpark entrance State highway 10
- 3 Entrance carpark State highway 1 toilets

Playground Upgarde Awanui Park

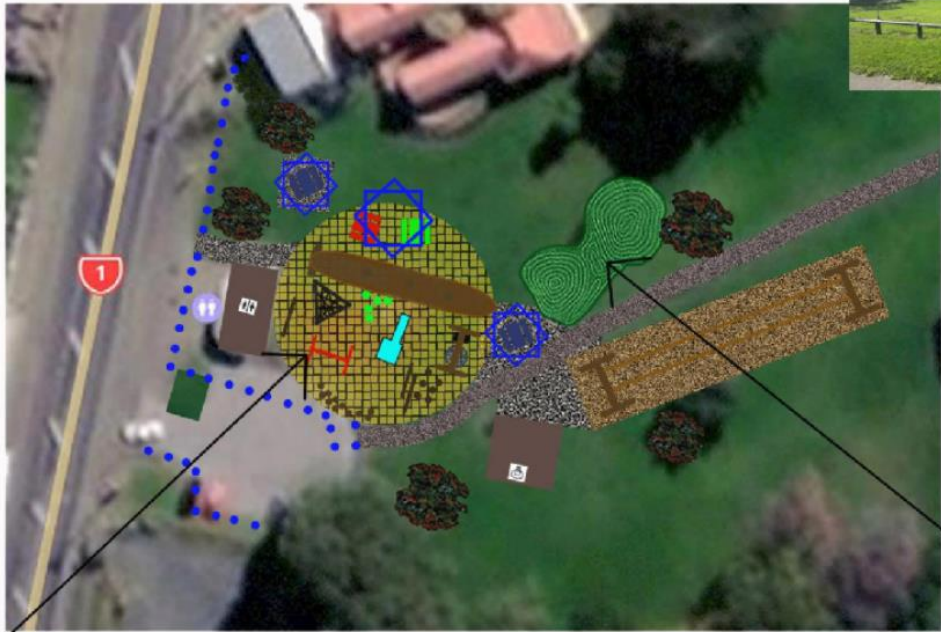

The upgraded playground will feature areas of natural play along with a playground boat. Where possible natural materials will be used these require less maintenance. The theme for the playground is nautical (Awanui river).



Existing play equipment (swings & fort slide) to be retained, playground enlarged creating a great family play , picnic space and event space.



The playground boat is to be modeled on the Apanui that sailed in an out of Awanui via Rangauni Harbour



The area immediately to the East of the enlarged playground features an earth mound enabling concerts and other events in the park. There is an existing outdoor stage on the adjacent north property available for public use.



07/08/2020 Sheet: 1

XCAPE DESIGN LTD
LANDSCAPE ARCHITECTS
0272810640
alan@xcape.co.nz

Awanui Playground Equipment for Revitalisation of the Park

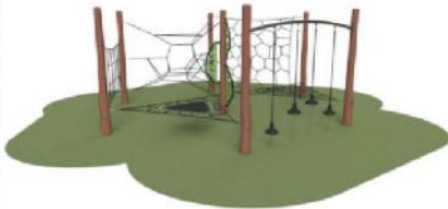
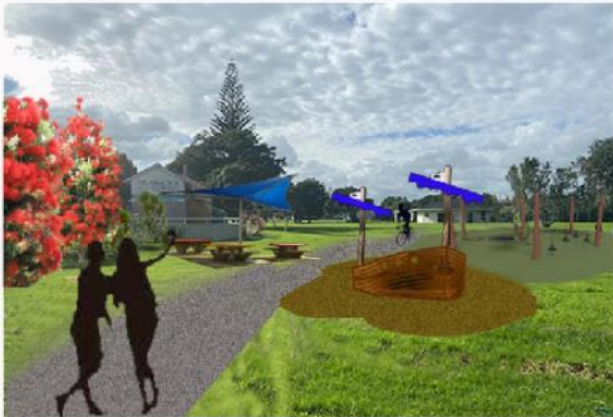

Photo-montage Entrance-way for Awanui Playground



19/09/2020 Sheet:3



XCAPE DESIGN LTD.
LANDSCAPE ARCHITECTS
0272810640
@xcape.shapen57@gmail.com

Playground Boat



Tommy the Tug becomes a playground area beside the new carpark on state highway 10





Awanui Toilet Block



New World Kumeu
Wire weed (Muehlenbeckia complexa)
Planted May 2015 image Google maps 2019



MUEHLENBECKIA COMPLEXA

A steel trace network around 3 sides of toilet block. This structure stepped off the building approx.800mm, provides access to maintain building. A steel gate locks access to this space.

Plant muehlenbeckia complexa in garden bed in front of the structure. The old wharf poles feature historical images mounted at the top of poles. The plants require approximately 3 -4 years to achieve good growth cover. Grasses such as Oioi to be planted in front of Wire weed climber.

15/04/2020
XCAPE DESIGN LTD
LANDSCAPE ARCHITECTS
0272810540
xcape@xcape.co.nz

Heading North Awanui Town Entrance

Awanui Streetscape Potentials to improve the look and feel of Awanui



Commerical signage on private road boundary can create a cluttered visual impact.
(We have no control over this)



Possible soft landscaping solution
Plant the swale drain with water filtering riparian plants
Expensive + requires maintenance



Transit NZ Signage
Visually appealing balanced vegetation at this point
Trees on left behind sign and fence with palms on right

Artwork Opportunity



Transit NZ Signage

Large public road reserve
Potential low soft landscaping opportunity



Possible planting solutions
Low + garden edged,
Palms behind sign



Artwork Opportunity
ACL Panels Local Artwork Opportunity



Existing Artwork



Awanui Town Centre Heading North

Awanui Streetscape Potentials to improve the look and feel of Awanui

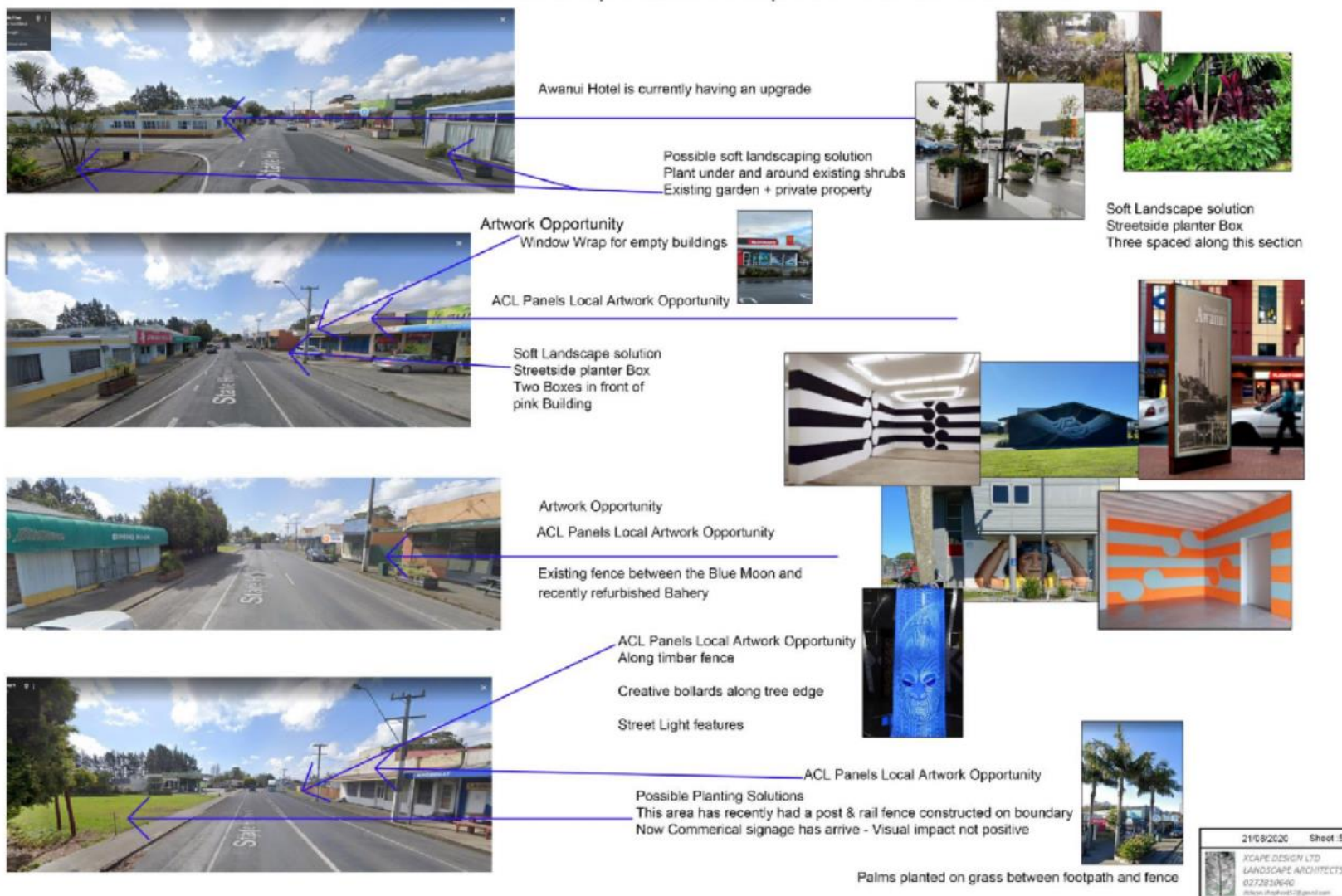

Awanui Town Centre Intersection State Highway 10 & State Highway 1
Awanui Streetscape Potential Opportunities

Diagram illustrating potential streetscape opportunities at the Awanui Town Centre Intersection, State Highway 10 & State Highway 1. The diagram includes several aerial views of the intersection and surrounding areas, with blue arrows pointing to specific locations for potential artwork or infrastructure. The opportunities are categorized as follows:

- ACL Panels
- Local Artwork Opportunity
- History Opportunity
- Bollards Nautical theme
- Artwork Opportunity Iwi art at intersection
- Surveyor Road Boundary: Place Bollards along Road edge move existing concrete blocks to legal boundary Creates a footpath between the road and boundary
- Bollards Nautical theme
- Artwork Opportunity Iwi Gateway at intersection
- Artwork Opportunity Power transformer
- Artwork Opportunity Shop wall painting
- Artwork Opportunity Power transformer
- Artwork Opportunity Iwi Gateway at intersection
- Bollards Nautical theme
- Artwork Opportunity Power transformer
- History Storyboard
- ACL Panel
- Art Opportunity water tanks

21/08/2020 Sheet 5

KCARE DESIGN LTD
LANDSCAPE ARCHITECTS
0272810640
@Kcare.Design

Awanui State Highway 10 Entrance Heading West/North
Awanui Streetscape Potentials to improve the look and feel of Awanui

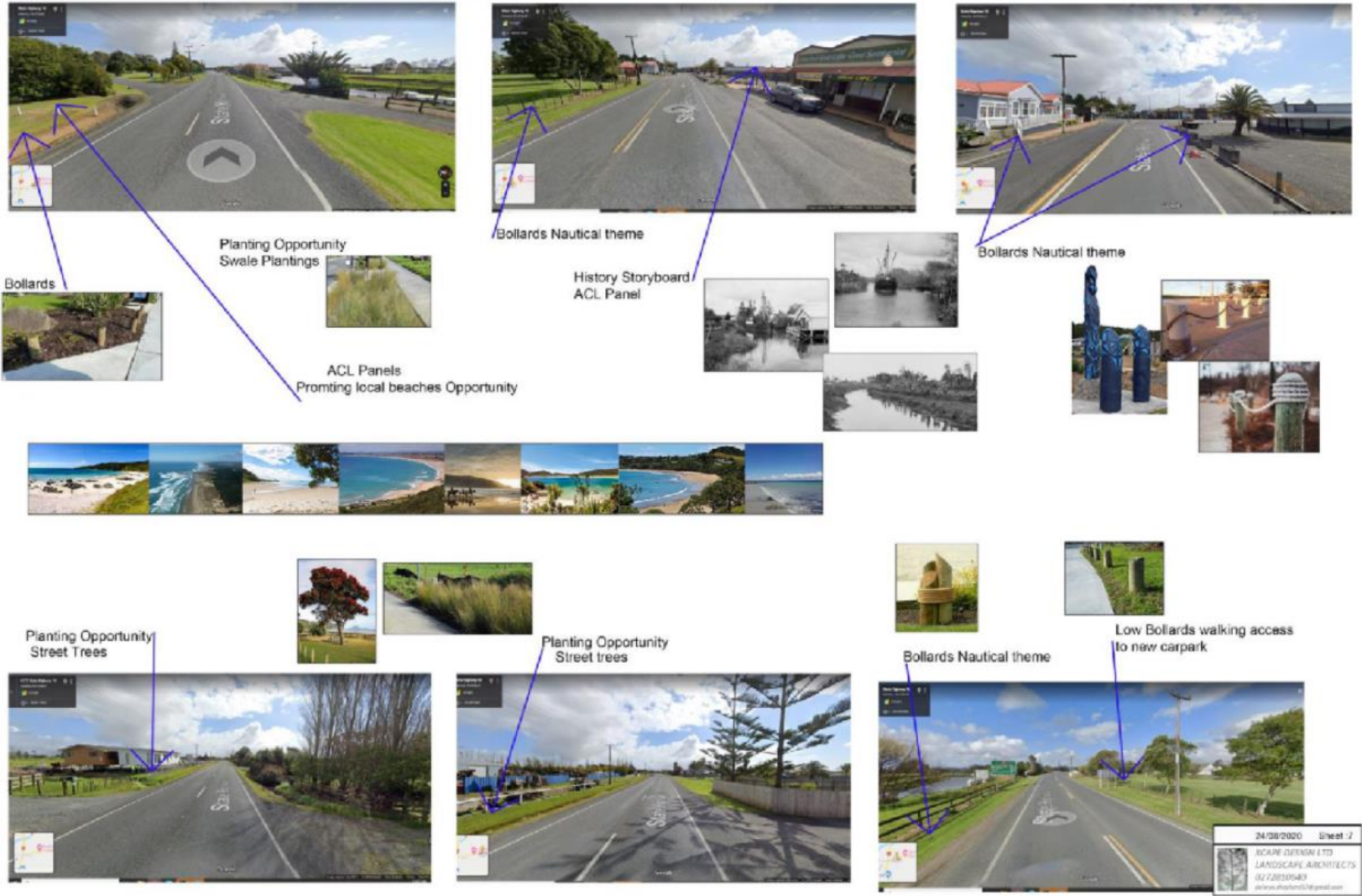

Heading South State Highway 1 Awanui

Awanui Streetscape Potentials to improve the look and feel of Awanui



Soft Landscape solution
Riparian planting





Art Opportunity





Planting Opportunity



Bollards Nautical theme



Soft Landscape solution
Riparian planting



Art Opportunity





25/08/2020 Sheet 3

 KSCAPE DESIGN LTD
LANDSCAPE ARCHITECTS
0272620540
www.kscapedesign.co.nz

Awanui Town Centre Park



Awanui Town Centre with Safer Street

Using temporary materials to upgrade the intersection

Slowing the speed wider shared space to move around the town and connect to the existing pack



- Public consultation
- The community really got behind this project.
- A total of four meetings occurred to come up plans that the majority would prefer for Awanui.

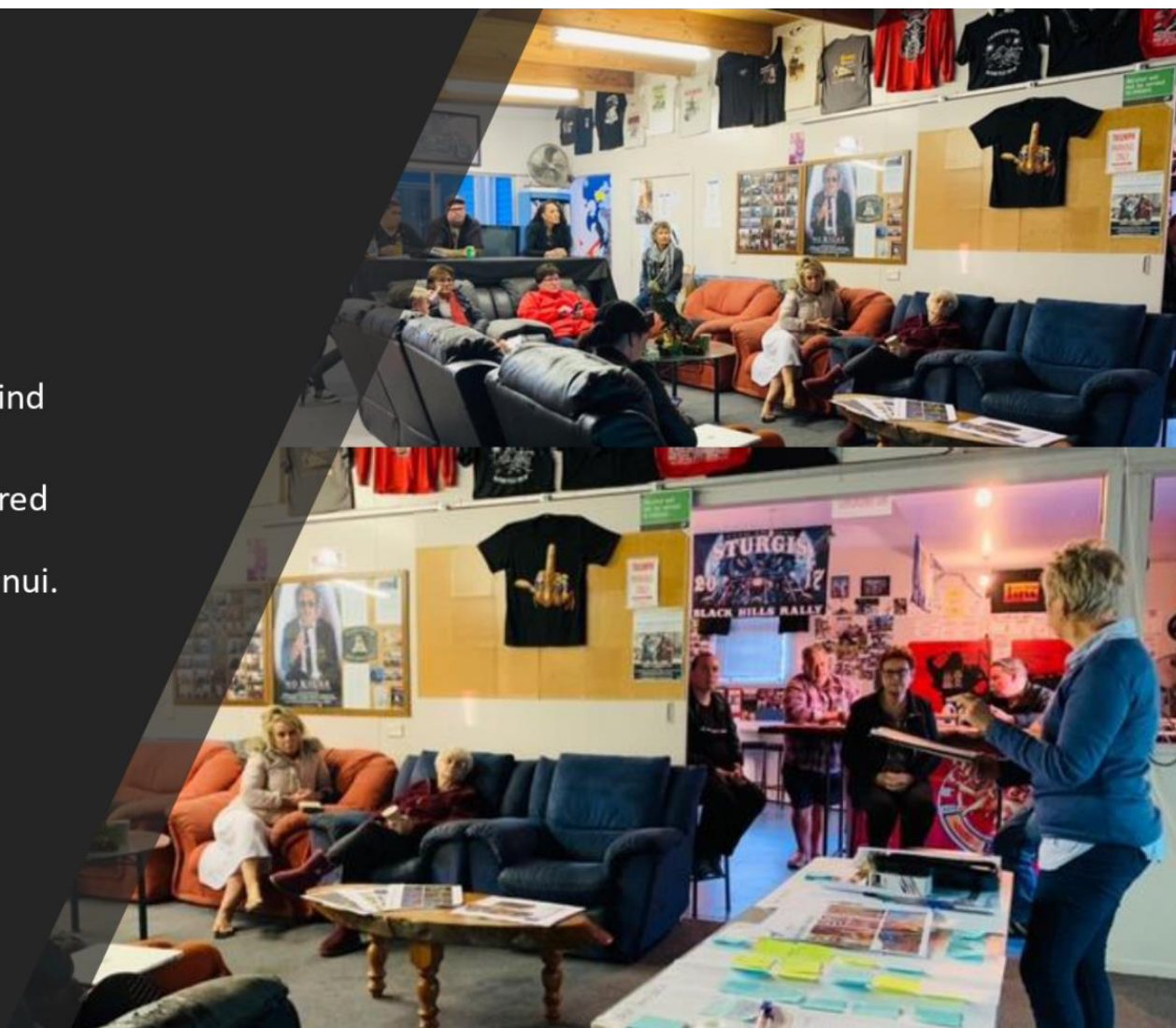

Community Consultation

The Proposal included consultation and collaboration with many stakeholders including the Te Hiku Community Board, Community Group Shine on Kaitia, Awanui Ratepayers Association, the Kaitia Business Association, the Northland Regional Council, and Te Hiku Iwi.

NZTA undertook a Township Plan for Awanui as part of an NZTA initiated project. The Ahipara Community Plan, the Kaitia Community Plan, and the Awanui Community Plan were also used as references for community direction.

Further consultation will occur with stakeholder groups and the public following the detailed design of the staged projects.



Landscape Concept Plan Korora Park

Ahipara



-  All wild pines removed providing view shafts planted with suitable amenity species
-  Existing Playground upgraded & extended with natural play equipment
-  Relic Sand Dunes planted with Spinifex & Pingao
-  Existing Sewer pump shed
-  Riparian planting area
-  Amenity planting area
-  Korora Street traffic calming Planned traffic barriers reduced to areas of one way slow traffic
-  Existing Car Park & New Car Parks
-  Existing beach tracks
-  Existing half court Painted with games
-  Existing Skate half pipe relocated
-  Existing Shade shelter fitted with B&O and concrete tables
-  New Bike Pump Track
-  New concrete Bird Chairs
-  New concrete Tables coloured tops
-  New shade umbrellas
-  New viewing deck & Yoga relaxation deck



Korora Street Park Ahipara Analysis of park structure + Potential opportunities

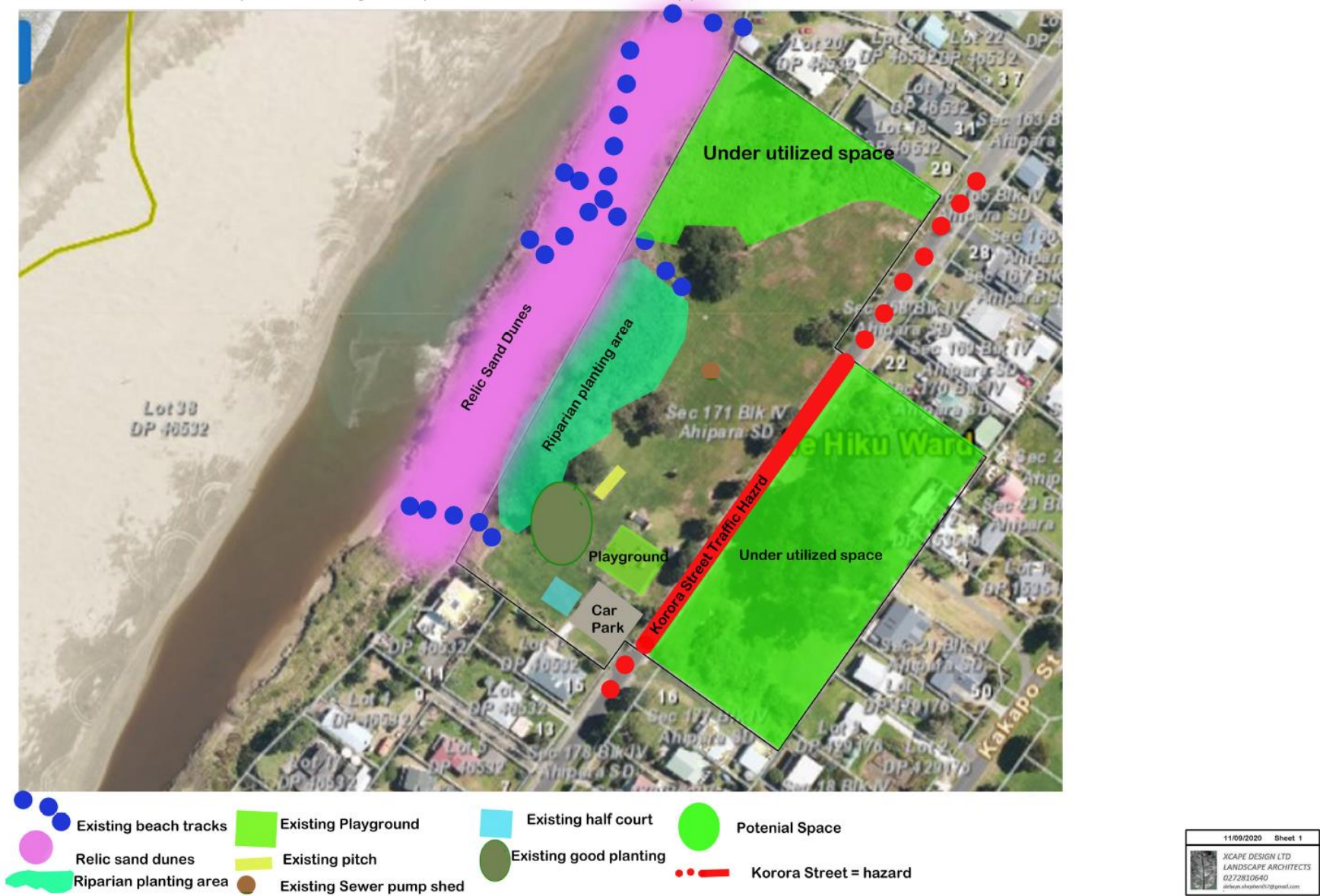

Landscape Concept Unahi Wharf

