

Local Authority: Far North District Council  
 Survey Block & District: Il Ahipara  
 Total Area: 75.8581ha  
 Comprised in: NA78D/2

**APPROVED PLAN**  
 Planner: Simeon McLean  
 pp: ENathan  
 RC: 2160143-RMAVAR/C  
 Date: 20/06/2023

MEMORANDUM OF EASEMENTS			
Purpose	Shown	Servient Tenement	Dominant Tenement
Right of Way (Pedestrian)	(A)	Lot 6	Lot 4

MEMORANDUM OF EASEMENTS IN GROSS			
Purpose	Shown	Servient Tenement	Grantee
Right to Convey Telecommunications	(B)	Lot 17	Chorus New Zealand Limited
Right to Convey Electricity			Top Energy Limited
Right to Convey Telecommunications	(C)	Lot 20	Chorus New Zealand Limited
Right to Convey Electricity			Top Energy Limited

THIS DRAWING AND DESIGN REMAINS THE PROPERTY OF VON STURMERS AND MAY NOT BE REPRODUCED WITHOUT THE WRITTEN PERMISSION OF VON STURMERS.

AREAS AND MEASUREMENTS SUBJECT TO FINAL SURVEY

This plan and accompanying report(s) have been prepared for the purpose of obtaining a Resource Consent only and for no other purpose. Use of this plan and/or information on it for any other purpose is at the user's risk.

Proposed Building Envelope

Tasman Sea

Section 1  
SO 469396

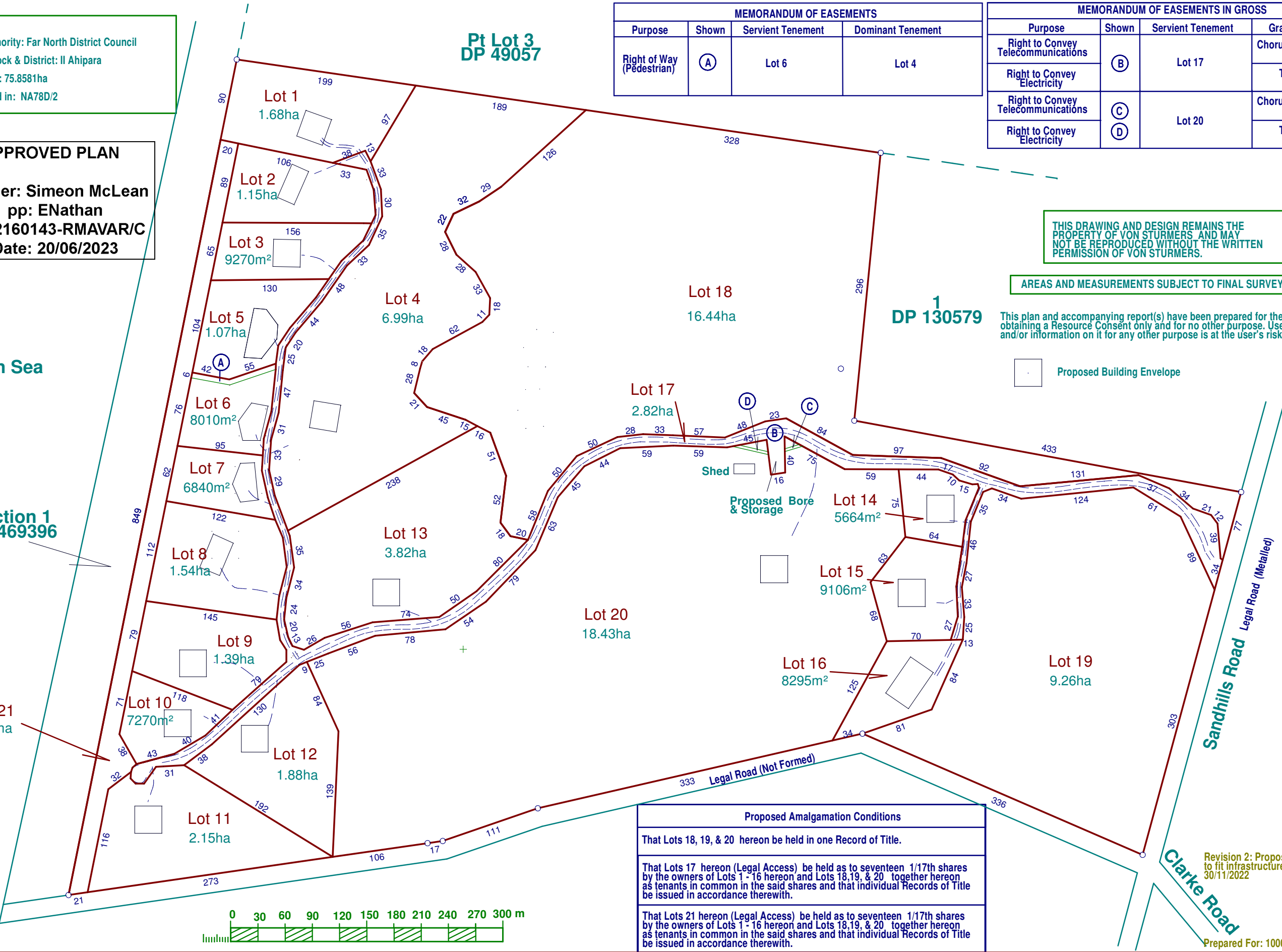

**Proposed Amalgamation Conditions**

That Lots 18, 19, & 20 hereon be held in one Record of Title.

That Lots 17 hereon (Legal Access) be held as to seventeen 1/17th shares by the owners of Lots 1 - 16 hereon and Lots 18, 19, & 20 together hereon as tenants in common in the said shares and that individual Records of Title be issued in accordance therewith.

That Lots 21 hereon (Legal Access) be held as to seventeen 1/17th shares by the owners of Lots 1 - 16 hereon and Lots 18, 19, & 20 together hereon as tenants in common in the said shares and that individual Records of Title be issued in accordance therewith.

Revision 2: Proposed boundaries amended to fit infrastructure, easements C & D added. 30/11/2022

Prepared For: 1000 Sandhills Ltd

CAD: 14905Amended Scheme Layout A3 30Nov22

**VON STURMERS**  
 Registered Land Surveyors, Planners & Land Development Consultants  
 Ph: (09) 408 6000 131 Commerce St  
 P.O. Box 128 Kaitaia  
 Email: kaitaia@surveyandplanning.co.nz

**Proposed Subdivision of Pt Lot 3 DP 49057  
 (Variation RC 2160143)**

	Name	Date	ORIGINAL SCALE	SHEET SIZE
Survey			1:3000	A2
Design				
Drawn	KS	16/09/2022		
Approved				
Rev 2	KS	30/11/2022		

Surveyors Ref. No:  
**14905**  
 Series  
 Sheet of