









LEGEND

-  Lower wall: Timber pole retaining wall 400 SED 9m pole length
-  Upper wall: Timber pole retaining wall 300 SED 6.0m pole length
-  Additional wall: Timber pole retaining wall 300 SED 6.0m pole length to be installed at completion of works
-  Property boundary
-  New terrace to allow progressive site access for retaining wall construction
-  Finished contours on new terrace
-  Existing exposed dwelling foundations (location measured by tape rather than survey)
-  Pohutaka tree stump (location measured by tape rather than survey)

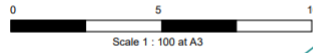

Notes:

1. Refer to Figure No.s 3 to 5 for locations and details of new timber pole retaining walls.
2. These drawings shall be read in conjunction with the NGS report, 1A Seaview Road, Paihia: Landslip remediation, dated March 2022. NGS Ref 0213.
3. Drawings shall be read in conjunction with SCS Drawings SK-SE-000 to -003.
4. All discrepancies to be referred to the Engineer for decision prior to proceeding with works.
5. All works to comply with Constructor's approved Health & Safety Manual and Health and Safety at Work Act 2015.
6. All works to comply with the Far North District Council Engineering Standards & Guidelines 2009.

LOT 2
DP 124280

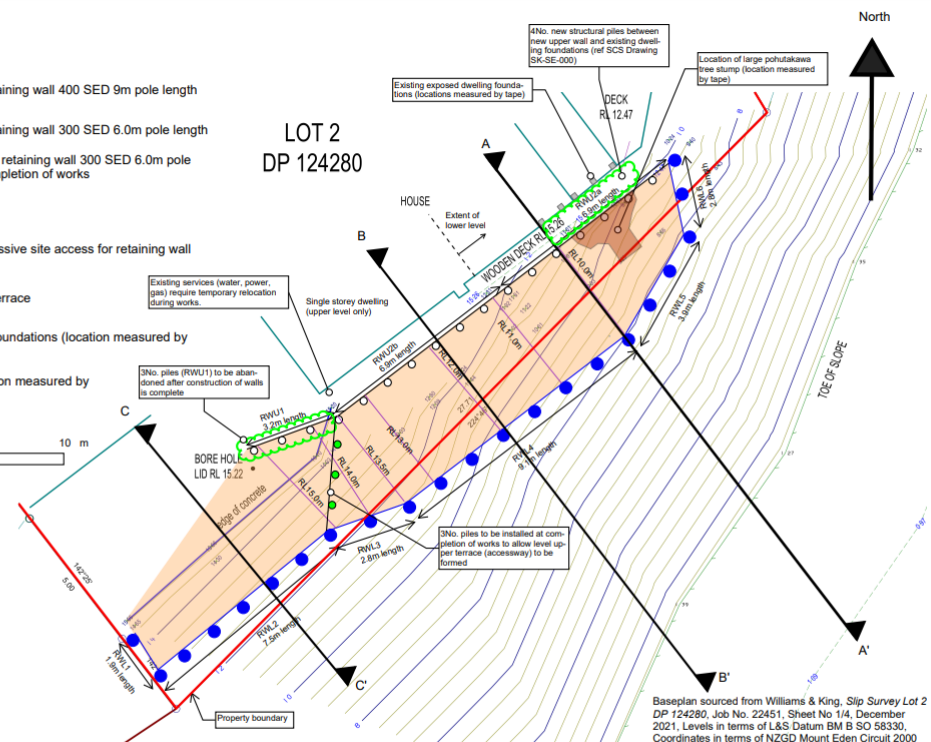

Baseplan sourced from Williams & King, Slip Survey Lot 2 DP 124280, Job No. 22451, Sheet No 1/4, December 2021. Levels in terms of L&S Datum BM B SO 58330, Coordinates in terms of NZGD Mount Eden Circuit 2000

Project No.	Date	Jane Banfield 1A Seaview Road, Paihia
0213	March 2022	
Figure No.	Revision	Site Plan
2	A	

FOR CONSTRUCTION
This drawing is not to be used for construction unless signed as approved
Signed: *DS Butten* Date: 11/03/2021

NGS
Northland Geotechnical Specialists
Ph: +64 226981129 E: info@northlandgeotech.co.nz