

Memorial Park proposed wharepaku: concept and form

Wharepaku building - design detail

ĀKAU proposes enhancing the visual impact of the wharepaku building through the following modifications:

- Extend rafters, primarily toward Station Road
- Add columns for privacy screening and interest
- Remove ShadowClad to walls and add patterning to exterior concrete walls
- Seating

We believe these simple moves will create a welcoming entry to the park and offer shelter for pedestrians and cyclists.

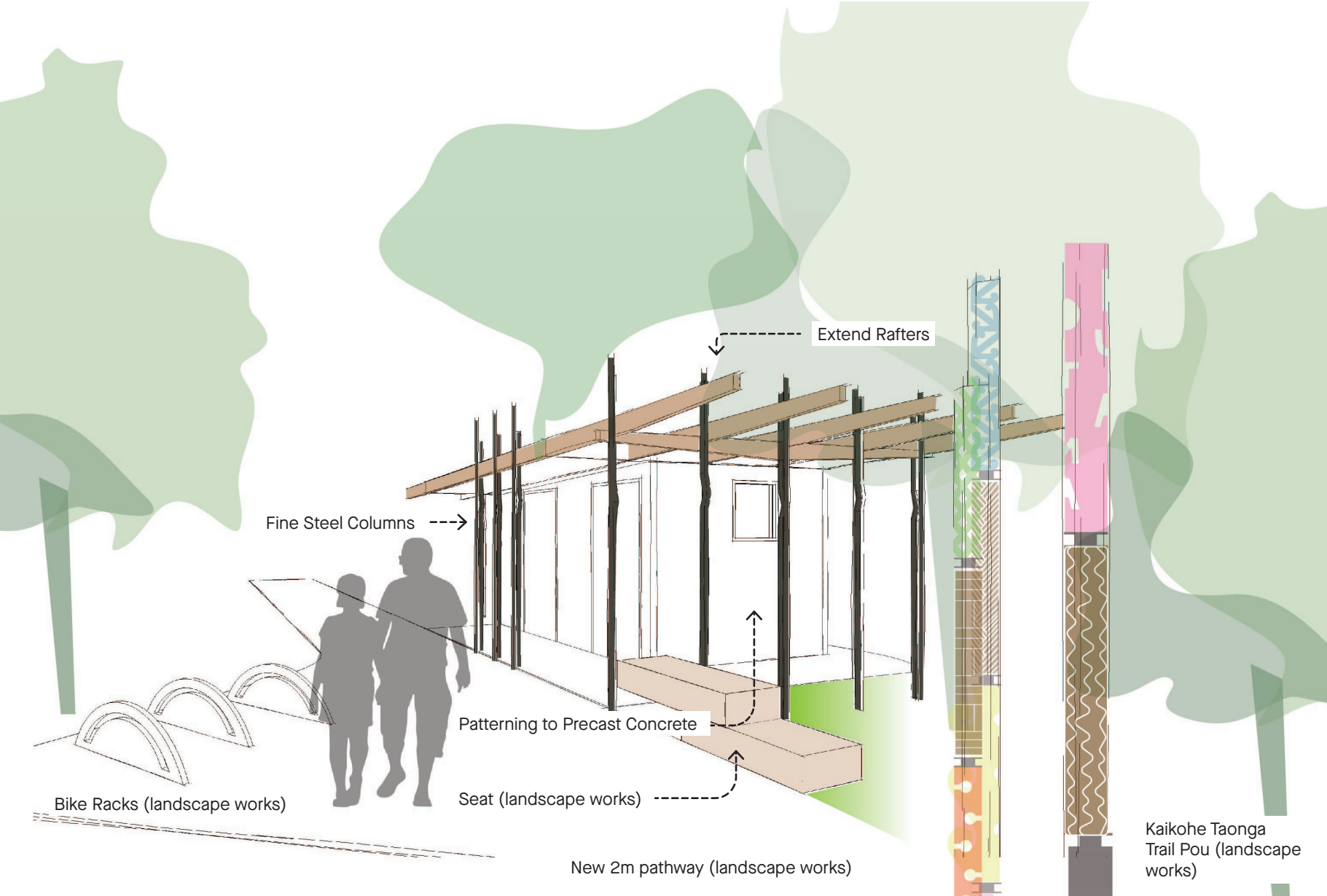

Location plan

Legend

1. Wharepaku building near Station Road
2. 2m wide concrete entrance path
3. 4 no. bike racks
4. Navigation signage
5. Tree to be removed
6. Taonga Trail Pou as markers to park entry - refer below

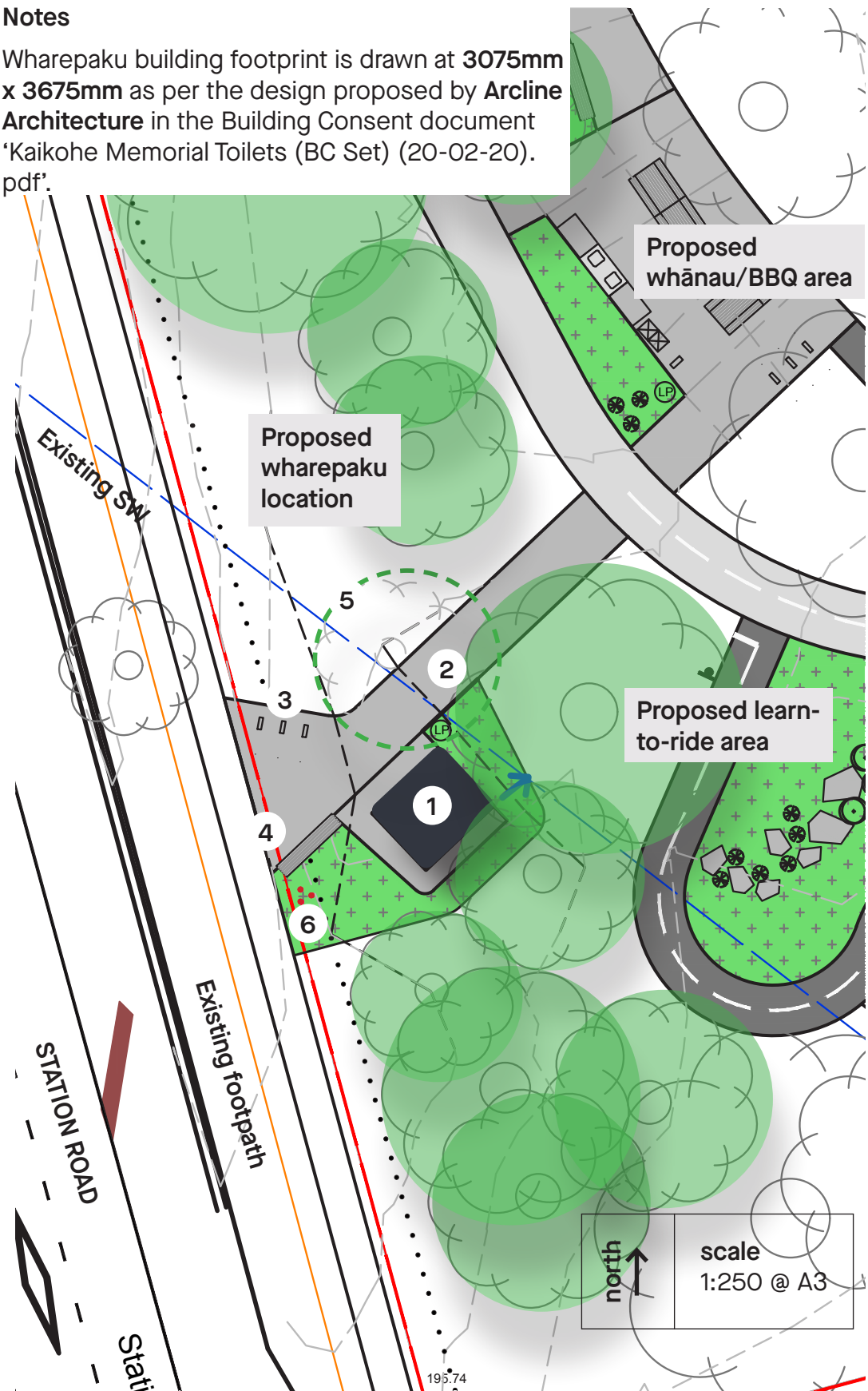

Notes

Wharepaku building footprint is drawn at 3075mm x 3675mm as per the design proposed by Arcline Architecture in the Building Consent document 'Kaikohe Memorial Toilets (BC Set) (20-02-20). pdf'.

Memorial Park proposed wharepaku: suggested material and treatment

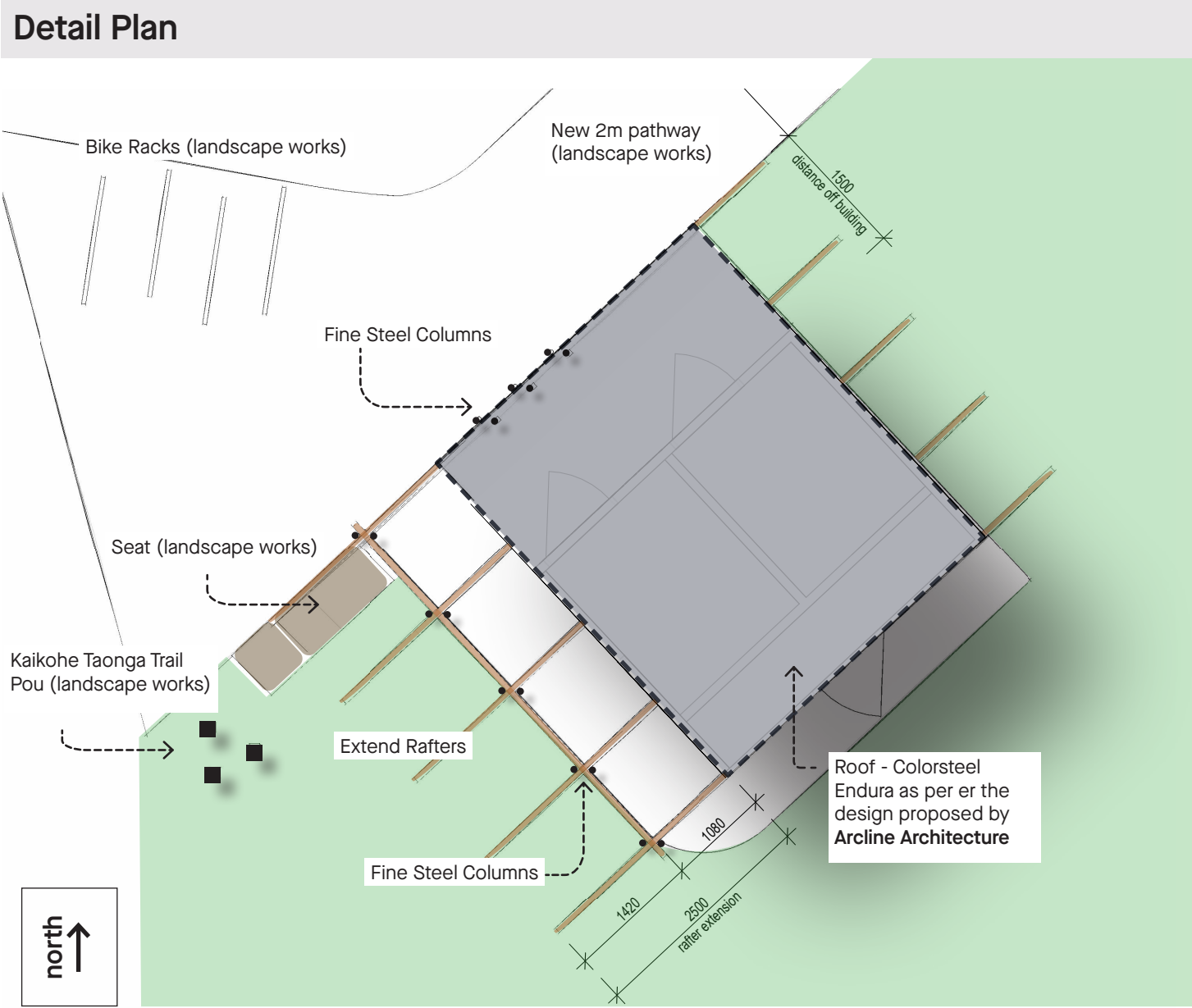

Fine steel columns

We propose columns are added to the extended roof structure to provide privacy and interest. Sketch shows slight bend/kink in columns to add visual interest. These are detailed as 50mm Circular Hollow Sections.

Lighting

Consider use of lighting on canopy structure to create a safe and welcoming space around wharepaku.

Precast Pattern and Colour

Coloured pattern and formwork to the precast concrete walls will help to make the wharepaku a positive and visually appealing addition to Memorial Park. We suggest the removal of the proposed ShadowClad and the addition of some patterning to exterior precast walls.

Indicative patterning based on the Kaikohe Taonga Trail Pou. Potential methodology: pattern to be pressed 20mm into precast, and pressed section to be painted. Please assume this will be to 60% of all four facades. Design TBC.