

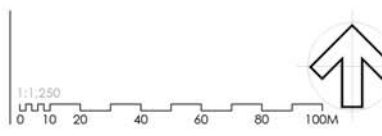

--- Site Boundary

PLEASE NOTE
 FOR CONSTRUCTION PURPOSES USE ONLY FIGURED DIMENSIONS. THIS DRAWING MUST ALWAYS BE READ IN CONJUNCTION WITH ALL RELEVANT PROJECT DETAILS. ALL DIMENSIONS MUST BE CHECKED ON SITE PRIOR TO COMMENCING. PLEASE REPORT ANY DISCREPANCY TO THE ARCHITECT OR CONTRACT ADMINISTRATOR. THE COPYRIGHT FOR THIS WORK IS RETAINED BY CREATIVE INTENTIONS UNLESS SPECIFICALLY RESTED TO THIRD PARTY UNDER LICENSE.
 © COPYRIGHT CREATIVE INTENTIONS 2015

Revisions



Drawing	Site context/location plan	Project Date	Aug 2015
Project/Client	Te Hiku Sports Hub, Kaitiaia Te Hiku Sports Trust	Scale @ A1	1:1250
ASD Reference Drawing number	15010-02-001	Revision	Approval



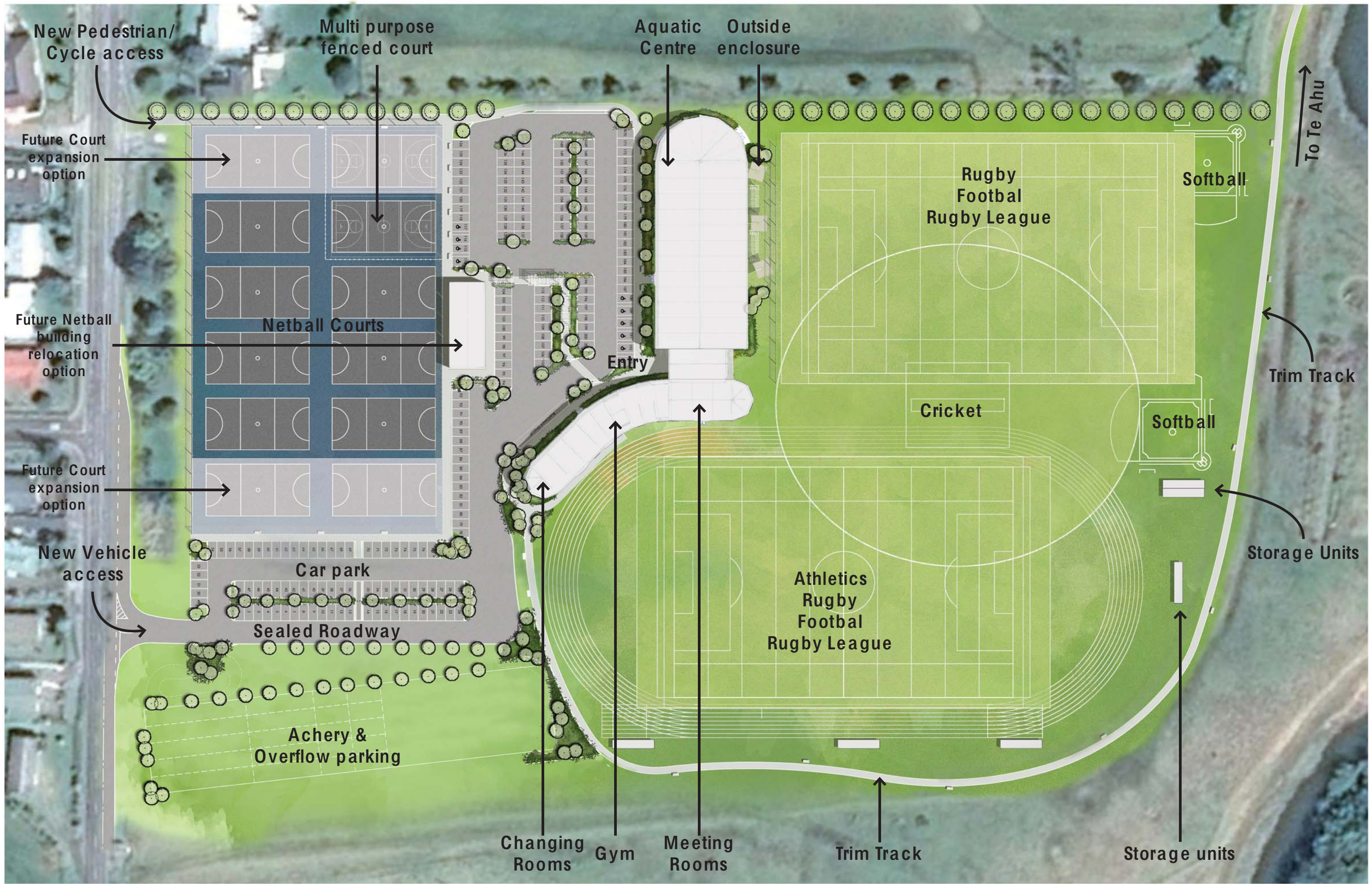

PLEASE NOTE
 FOR CONSTRUCTION PURPOSES USE ONLY FIGURED DIMENSIONS. THIS DRAWING MUST ALWAYS BE READ IN CONJUNCTION WITH ALL RELEVANT PROJECT DETAILS. ALL DIMENSIONS MUST BE CHECKED ON SITE PRIOR TO COMMENCING. PLEASE REPORT ANY DISCREPANCY TO THE ARCHITECT OR CONTRACT ADMINISTRATOR. THE COPYRIGHT FOR THIS WORK IS RETAINED BY CREATIVE INTENTIONS UNLESS SPECIFICALLY TESTED TO THIRD PARTY UNDER LICENSE.
 © COPYRIGHT CREATIVE INTENTIONS 2015

Revisions

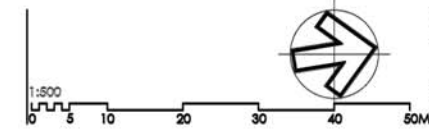

Drawing Site concept plan	Project Date Aug 2015
Project/Client Te Hiku Sports Hub, Kaitiaki Te Hiku Sports Trust	Scale @ A1 1:500
15010-02-002	Purpose of Issue Approval

