

| Existing Easements | | | |
|-----------------------------|--------------------|------------------------------|---|
| Purpose | Shown | Servient Tenement | Dominant Tenement |
| Right of way | (A) (P) (L) | Lot 1 hereon | Lot 2 DP 409889 Lot 1 DP 161732 Lot 2 DP 161732 Lot 3 DP 144820 Lot 5 DP 144820 Lot 6 DP 144820 Lot 7 DP 144820 |
| Right to convey electricity | (A) (F) | Lot 1 hereon | Lot 2 DP 409889 Lot 1 DP 161732 Lot 2 DP 161732 Lot 3 DP 144820 Lot 5 DP 144820 Lot 6 DP 144820 Lot 7 DP 144820 |
| Right to convey water | (F) | Lot 1 hereon | Lot 6 DP 144820 Lot 7 DP 144820 |
| Right of way | (B) (C) (V) (H) | Lot 1 hereon Lot 2 hereon | Lot 2 DP 409889 Lot 1 DP 161732 Lot 2 DP 161732 Lot 3 DP 144820 Lot 5 DP 144820 |
| Right of way | (H) | Lot 1 hereon | Lot 2 DP 409889 |
| Right to convey electricity | (E) (G) | Lot 1 hereon | Lot 2 DP 409889 Lot 3 DP 144820 |



| Conditional Easements | | | |
|---|----------------------------|--------------|--------------|
| Purpose | Shown | Servient | Dominant |
| Right of way, and right to convey electricity, telecommunications, water and computer media | (A) (B) (C) (F) (L) (V) | Lot 1 hereon | Lot 2 hereon |

| Proposed Easements | | | |
|-----------------------------|-----------------------------------|------------------------------|---|
| Purpose | Shown | Servient | Dominant |
| Right of way | (D) | Lot 2 DP 144820 | Lot 1 hereon Lot 2 hereon & Lot 3 DP 144820 |
| Right of way | (E) (G) | Lot 3 DP 144820 | Lot 2 hereon & Lot 1 hereon |
| Right of way | (B) | Lot 2 hereon | Lot 1 hereon |
| Right to convey electricity | (A) (I) (C) (F) (L) (V) (H) | Lot 1 hereon Lot 2 hereon | Cap Energy Ltd |

(E) is an existing right of way (shown X on DP 144820) over Lot 3 DP 144820
 Note also corrupted water supply easement W on DP 105513.
 W is referred in doc 8834423.4 as being servient on Lot 5 DP 79532
 but shown on DP 105513 as being servient on P 3 DP 79532 (now Lot 2 DP 144820).

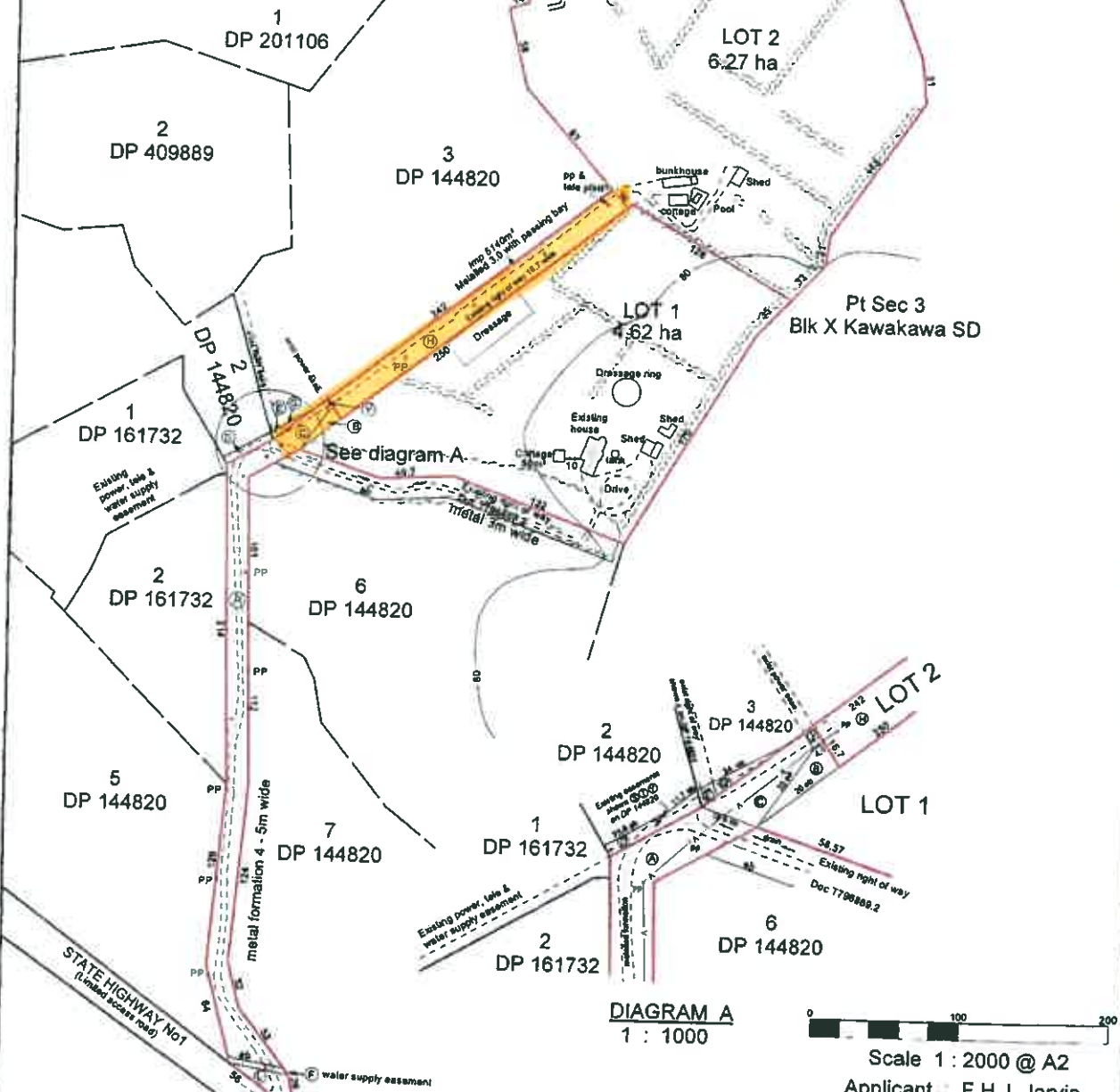

DIAGRAM A
1 : 1000

Scale 1 : 2000 @ A2
 Applicant : F.H.J. Jarvis
 Title : NA36B/753
 Area : 10.9340 ha
 Zoned : Rural Production

DONALDSONS
REGISTERED LAND SURVEYORS

**LOTS 1 & 2 BEING A
 PROPOSED SUBDIVISION OF
 LOT 5 DP 79532 AND EASEMENTS
 OVER LOTS 2 & 3 DP 144820**

6907 TOPO - Scheme Plan
 11 January 2017
 Ref 6907

* New Road.

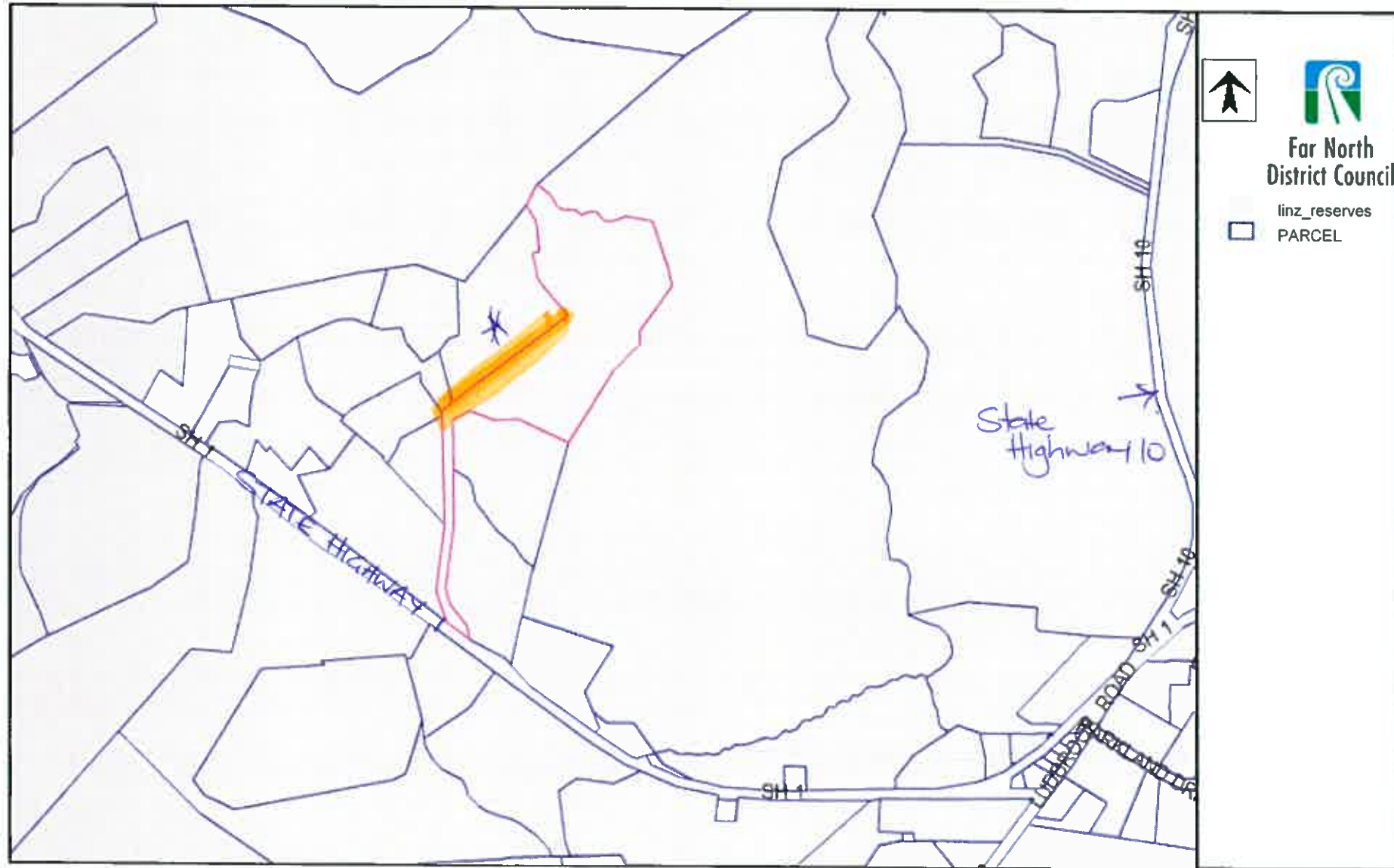

This map has been provided in good faith and for information purposes only. The Far North District Council is not liable for any errors or omissions. Any persons considering purchasing property are advised to have all boundaries confirmed by a licensed Cadastral Surveyor.

Produced by the Far North District Council 09:30 15/06/2017

Copyright © 2016 Far North District Council